



CECIL COUNTY
DEPARTMENT OF PUBLIC WORKS

NOTIFICATION OF ROAD/BRIDGE CLOSURE

ROAD NAME	Marley Road – Elkton, MD	
BRIDGE NO.	N/A	
CROSSING	N/A	
HOUSE #'S	House numbers- 21, 31, 43, 49, 57 (Intersection of Rt. 40 and Marley Road to intersection of Marley Road and Meadow Hall Road)	
Reason for Closure	Sewer Expansion Project	
Date & Time	October 22, 2018	
Duration of Closure (start/end)	Approximately 3 months	
Detour Plan Attached	X- YES	NO

EMERGENCY EQUIPMENT WILL HAVE ACCESS BUT WILL NEED TO MOVE BARRICADES

AGENCY / ENTITY CONDUCTING CLOSURE	Department of Public Works- Engineering & Construction	
CONTACT PERSON	Mike Evans	
CONTACT NUMBER	410-996-5268	
RADIO OPS	Craig Marker	
PROJECT MANAGER	410-996-5268	
CONTACT NUMBER		

Questions: Please call the Contact Person listed above.
In the event you cannot reach the Contact Person please call the Project Manager.

COMMENTS: Emergency equipment and local residents will have access to house numbers 21, 31, 43, 49 and 57 on Marley Road from the north via Nottingham Road. There will be no access via route 40.

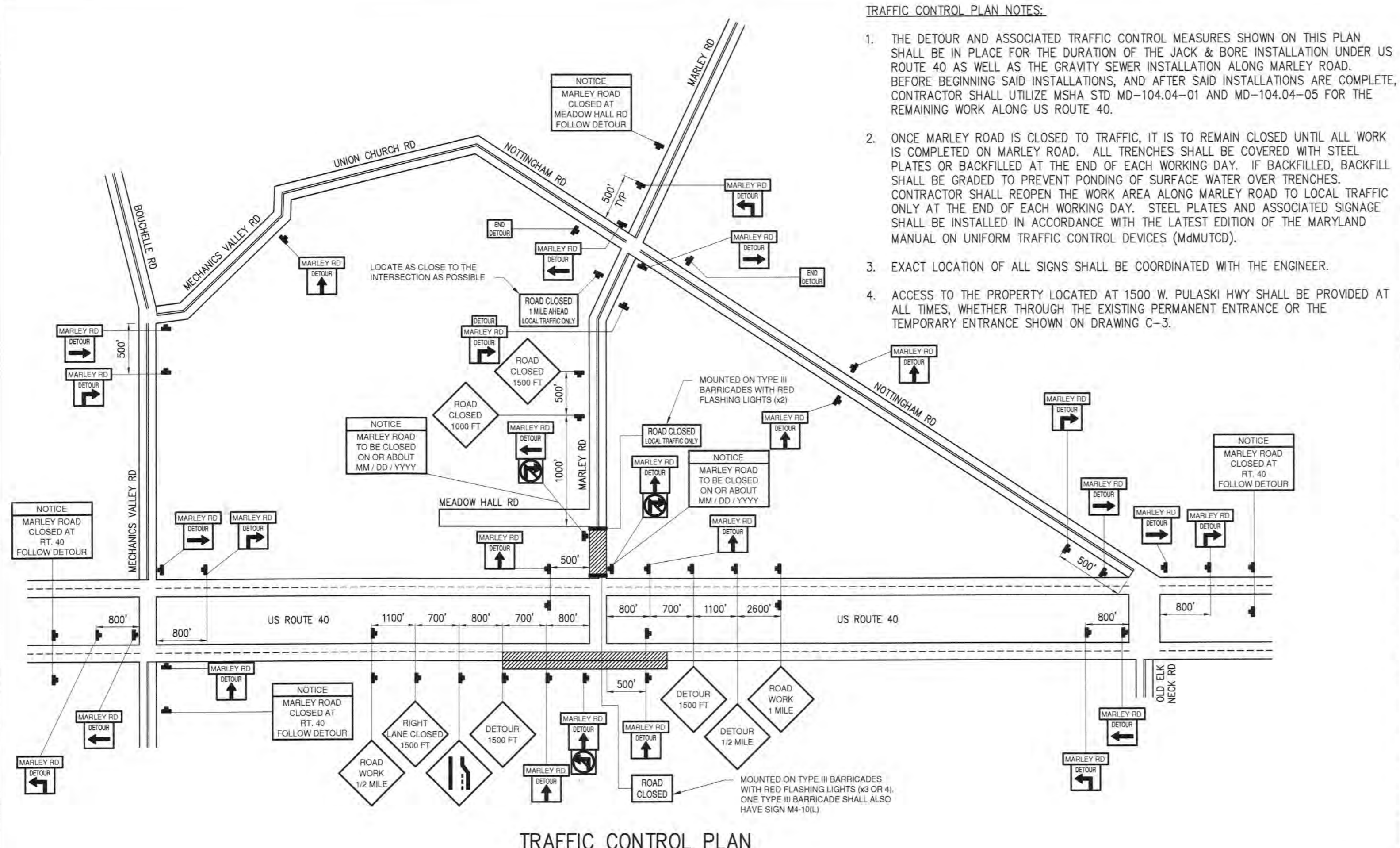

TRAFFIC CONTROL PLAN NOTES:

1. THE DETOUR AND ASSOCIATED TRAFFIC CONTROL MEASURES SHOWN ON THIS PLAN SHALL BE IN PLACE FOR THE DURATION OF THE JACK & BORE INSTALLATION UNDER US ROUTE 40 AS WELL AS THE GRAVITY SEWER INSTALLATION ALONG MARLEY ROAD. BEFORE BEGINNING SAID INSTALLATIONS, AND AFTER SAID INSTALLATIONS ARE COMPLETE, CONTRACTOR SHALL UTILIZE MSHA STD MD-104.04-01 AND MD-104.04-05 FOR THE REMAINING WORK ALONG US ROUTE 40.
2. ONCE MARLEY ROAD IS CLOSED TO TRAFFIC, IT IS TO REMAIN CLOSED UNTIL ALL WORK IS COMPLETED ON MARLEY ROAD. ALL TRENCHES SHALL BE COVERED WITH STEEL PLATES OR BACKFILLED AT THE END OF EACH WORKING DAY. IF BACKFILLED, BACKFILL SHALL BE GRADED TO PREVENT PONDING OF SURFACE WATER OVER TRENCHES. CONTRACTOR SHALL REOPEN THE WORK AREA ALONG MARLEY ROAD TO LOCAL TRAFFIC ONLY AT THE END OF EACH WORKING DAY. STEEL PLATES AND ASSOCIATED SIGNAGE SHALL BE INSTALLED IN ACCORDANCE WITH THE LATEST EDITION OF THE MARYLAND MANUAL ON UNIFORM TRAFFIC CONTROL DEVICES (MdMUTCD).
3. EXACT LOCATION OF ALL SIGNS SHALL BE COORDINATED WITH THE ENGINEER.
4. ACCESS TO THE PROPERTY LOCATED AT 1500 W. PULASKI HWY SHALL BE PROVIDED AT ALL TIMES, WHETHER THROUGH THE EXISTING PERMANENT ENTRANCE OR THE TEMPORARY ENTRANCE SHOWN ON DRAWING C-3.

SYMBOL LEGEND

- SIGN
- BARRICADE
- ▨ WORK AREA

SIGN LEGEND

SIGN	MSHA SIGN NO.
	W20-1(1)
	W20-2(1)
	W20-3(1) 36"x36"
	W20-5(1)
	W4-2R
	R11-3a
	R11-3a Mod. 60"x22"
	R11-2
	M4-9(1)
	M4-8(1) 24"x18"
	M4-9(L) 30"x24"
	M4-9(L) Mod. 30"x24"
	M4-9 30"x24"
	M4-9(R) Mod. 30"x24"
	R3-2
	R3-1

NOTES FOR WORK IN THE CECIL COUNTY ROAD RIGHT-OF-WAY

1. ALL WORK IN THE CECIL COUNTY ROAD RIGHT-OF-WAY SHALL BE SUBJECT TO INSPECTION BY THE CECIL COUNTY DEPARTMENT OF PUBLIC WORKS.
2. THE CONTRACTOR SHALL MAINTAIN, AT THE WORK SITE, A COPY OF THE DRAWINGS AND OTHER DOCUMENTS REQUIRED.
3. THE CONTRACTOR SHALL ERECT AND MAINTAIN ALL NECESSARY SIGNS, BARRICADES, DETOUR SIGNS AND WARNING DEVICES REQUIRED TO SAFELY DIRECT TRAFFIC OVER OR AROUND THE PART OF THE HIGHWAY WHERE PERMITTED OPERATIONS ARE TO BE PERFORMED, SO LONG AS WORK DOES NOT INTERFERE WITH TRAFFIC, IN ACCORDANCE WITH THE LATEST EDITION OF THE FEDERAL HIGHWAY ADMINISTRATION'S M.U.T.C.D., PURSUANT TO THE ANNOTATED CODE OF MARYLAND, TRANSPORTATION ARTICLE, TITLE 25, SECTION 104.
4. ALL ACTIVITIES IN THE CECIL COUNTY ROAD RIGHT-OF-WAY, WHERE APPLICABLE, MUST CONFORM TO THE CECIL COUNTY ROAD CODE AND STANDARD SPECIFICATIONS FOR DESIGN AND CONSTRUCTION.
5. NO TRENCH WILL BE ALLOWED TO REMAIN OPEN AFTER THE NORMAL WORKDAY. IF A TRENCH IS TO REMAIN OPEN, STEEL PLATES AND PROPER TRAFFIC CONTROL SIGNS FOR THE MAINTENANCE OF TRAFFIC SHALL BE INSTALLED IN ACCORDANCE WITH THE M.U.T.C.D.
6. AFTER COMPLETION OF UTILITY WORK, ALL MATERIALS AND DEBRIS SHALL BE CLEARED FROM COUNTY ROADWAYS AND RIGHT-OF-WAY AND THE CONTRACTOR SHALL BE RESPONSIBLE FOR AS GOOD OR BETTER RESTORATION OF THE SITE.
7. CECIL COUNTY SHALL NOT BE HELD RESPONSIBLE FOR ANY ACCIDENTS OR DAMAGES RESULTING FROM ANY UNSAFE CONDITION DURING THE CONSTRUCTION, OR, AS A RESULT OF THE CONSTRUCTION.
8. IF CONSTRUCTION REQUIRES THE ALTERATION OR REMOVAL OF ALL OR PART OF ANY EXISTING STRUCTURE WITHIN THE COUNTY RIGHT-OF-WAY WHICH IS NOT ADDRESSED IN THE PLANS, THE CONTRACTOR SHALL NOT PERFORM THIS WORK WITHOUT FIRST OBTAINING THE WRITTEN APPROVAL OF THE CECIL COUNTY DEPARTMENT OF PUBLIC WORKS, WHICH APPROVAL SHALL BE AMENDMENT TO THE PROJECT.
9. THE CECIL COUNTY DEPARTMENT OF PUBLIC WORKS MAY DEVELOP POLICIES AND PROCEDURES TO ESTABLISH PROCEDURAL ACTIVITIES PURSUANT TO THESE RULES AND REGULATIONS.
10. THE CONTRACTOR SHALL NOTIFY "MISS UTILITY" AT 1-800-257-7777, FORTY-EIGHT (48) HOURS IN ADVANCE OF ANY WORK.

TRAFFIC CONTROL PLAN

NTS

NOTES FOR WORK IN THE MARYLAND STATE HIGHWAY ADMINISTRATION RIGHT-OF-WAY

PAVING SECTION (FOR ALL PAVING IN THE MSHA RIGHT-OF-WAY)

- 2" HOT MIX ASPHALT SUPERPAVE 12.5 MM FOR SURFACE, PG 64-22, LEVEL 2
- 6" HOT MIX ASPHALT SUPERPAVE 19.0 MM FOR BASE, PG 64-22, LEVEL 2 (TWO 3" LIFTS)
- 12" BASE COURSE USING GRADED AGGREGATE (TWO 6" LIFTS)

PAVEMENT NOTES

1. BITUMINOUS CONCRETE BAND DESIGNATIONS ARE MARYLAND STATE HIGHWAY ADMINISTRATION.
2. BITUMINOUS CONCRETE AND GRADED AGGREGATE BASE COURSE SHALL BE MIXED AND PLACED IN ACCORDANCE WITH THE LATEST MSHA SPECIFICATIONS.
3. THE CONTRACTOR SHALL BE FAMILIAR WITH THE GEOTECHNICAL REPORT FOR THIS SITE.
4. ALL PAVING WITHIN THE MSHA RIGHT-OF-WAY, INCLUDING DRIVEWAYS AND ACCESS ROADS, SHALL BE PAVED IN ACCORDANCE WITH THE PAVING SECTION LISTED ABOVE AND MSHA STANDARDS. PAVEMENT OPENINGS FOR UTILITY TRENCHES SHALL BE REPAIRED IN ACCORDANCE WITH STANDARD NO. MD 578.01 AND USING THE AFOREMENTIONED PAVING SECTION.
5. WHERE THE PROPOSED PIPE IS LOCATED IN THE SHOULDER OF US ROUTE 40, THE FULL WIDTH OF THE SHOULDER SHALL BE MILLED AND OVERLAID WITH 2" HOT MIX ASPHALT SUPERPAVE 12.5 MM, PG 64-22, LEVEL 2.

TRAFFIC CONTROL NOTE

THE FOLLOWING STANDARDS (CONSTRUCTION AND TEMPORARY TRAFFIC CONTROL) ARE REQUIRED FOR THIS PROJECT:

- A. SHOULDER WORK/DIVIDED UNCON. GREATER THAN 40 MPH STANDARD NO. MD 104.04-01
- B. RIGHT LANE CLOSURE/DIVIDED UNCON. GREATER THAN 40 MPH STANDARD NO. MD 104.04-05

FOR ALL STANDARDS REFERENCED ON THE PLAN, THE CONTRACTOR SHALL REFER TO THE MSHA BOOK OF STANDARDS WHICH WILL HAVE THE MOST CURRENT VERSION. THE BOOK OF STANDARDS CAN BE ACCESSED AT THE MSHA WEBSITE AT WWW.MARYLANDROADS.COM BY GOING TO THE BUSINESS SECTION AND FOLLOWING THE BUSINESS STANDARDS AND SPECIFICATIONS LINK, OR DIRECTLY AT:

HTTP://APPS.ROADS.MARYLAND.GOV/BUSINESSWITHSHA/BIZSTDSSPECS/DESMANUALSTDPUB/PUBLICATIONSONLINE/OHD/BOOKSTD/INDEX.ASP

ALL ITEMS ARE TO BE CONSTRUCTED IN ACCORDANCE WITH THE CURRENT VERSION OF THE REFERENCED STANDARDS AT THE TIME OF CONSTRUCTION.

UTILITIES NOTE

1. THE EXISTING UTILITIES SHOWN ON THE CONSTRUCTION PLANS ARE SCHEMATIC ONLY AND ARE NOT TO BE CONSIDERED TO BE COMPLETE. THE CONTRACTOR SHALL BE RESPONSIBLE FOR NOTIFYING ALL UTILITY COMPANIES PRIOR TO CONSTRUCTION SO THAT ALL UTILITIES CAN BE LOCATED IN THE FIELD. THE CONTRACTOR SHALL LOCATE EXISTING UTILITIES A MINIMUM OF TWO (2) WEEKS IN ADVANCE OF CONSTRUCTION OPERATIONS IN THE VICINITY OF THE UTILITIES. ANY DAMAGE INCURRED BY THE CONTRACTOR SHALL BE REPAIRED IMMEDIATELY AT THE CONTRACTOR'S EXPENSE.
2. CONSTRUCTION SHALL BE COMPLETED IN ACCORDANCE WITH THE MSHA STANDARD SPECIFICATIONS FOR CONSTRUCTION AND MATERIALS, LATEST EDITION, AND ALL AMENDMENTS.
3. THE CONTACT PERSON FOR MSHA DISTRICT 2 IS MR. BARRY CLOTHIER, DISTRICT UTILITY ENGINEER, 410-778-3061.

NOTICE
MARLEY ROAD CLOSED AT RT. 40 FOLLOW DETOUR

R11-2(7) Mod., 28" HIGH x 48" WIDE

TOP SECTION COLOR SCHEME: BLACK LETTERS ON FLUORESCENT YELLOW

BOTTOM SECTION COLOR SCHEME: BLACK LETTERS ON WHITE

NOTICE
MARLEY ROAD CLOSED AT MEADOW HALL RD FOLLOW DETOUR

R11-2(7) Mod., 28" HIGH x 48" WIDE

TOP SECTION COLOR SCHEME: BLACK LETTERS ON FLUORESCENT YELLOW

BOTTOM SECTION COLOR SCHEME: BLACK LETTERS ON WHITE

NOTICE
MARLEY ROAD TO BE CLOSED ON OR ABOUT MM/DD/YYYY

R11-2(6) Mod., 36" HIGH x 48" WIDE

TOP SECTION COLOR SCHEME: BLACK LETTERS ON FLUORESCENT YELLOW

BOTTOM SECTION COLOR SCHEME: BLACK LETTERS ON WHITE

INSTALL THIS SIGN THREE (3) WEEKS PRIOR TO ROAD CLOSURE. REMOVE ONCE CLOSURE IS IN PLACE.

DETAILS – ROAD CLOSURE NOTICE SIGNS

NTS

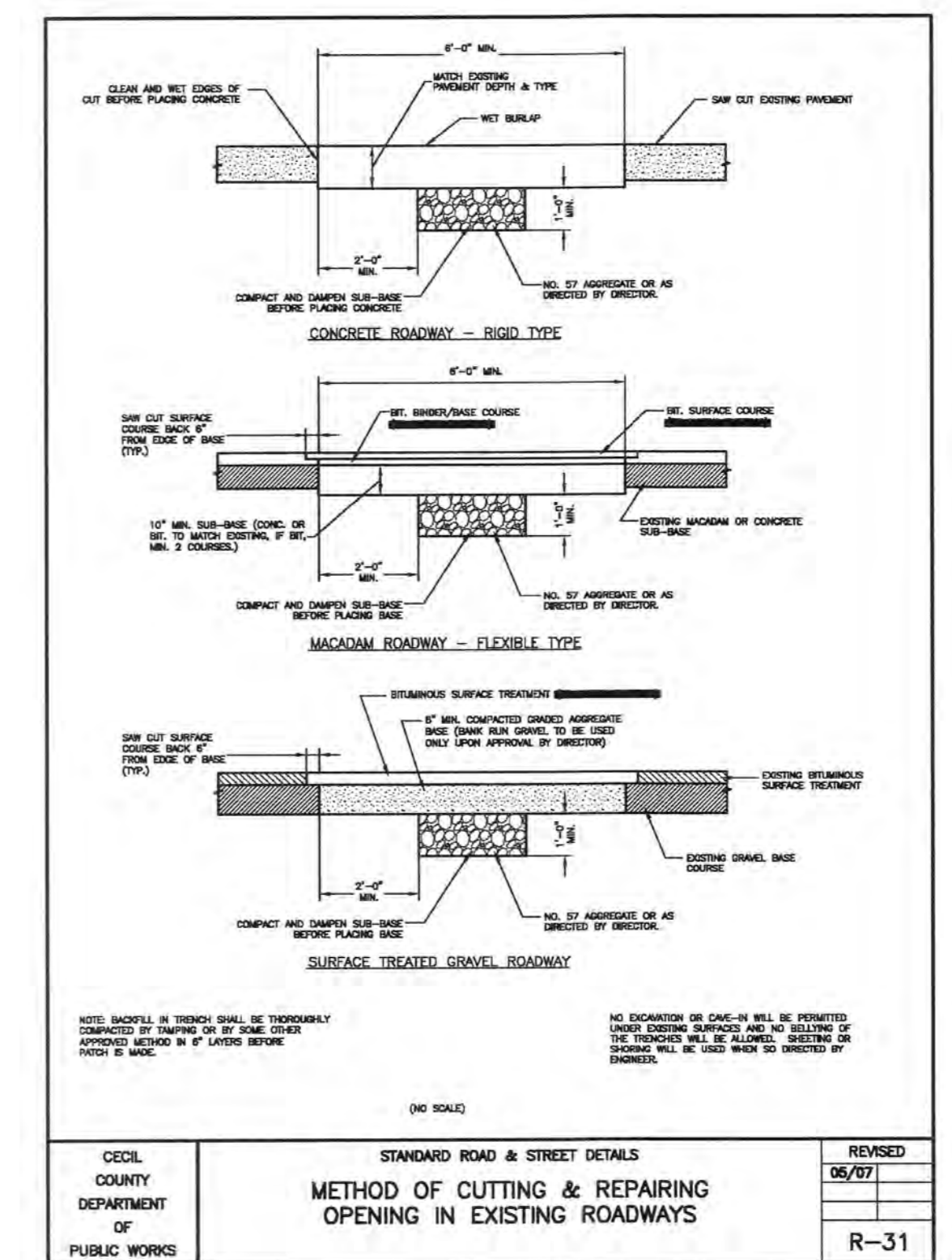

NOTE: THIS DETAIL SHALL NOT BE USED FOR ANY WORK IN THE MSHA RIGHT-OF-WAY.

PAVING SECTION IN CECIL COUNTY R/W:

- 2" HOT MIX ASPHALT SUPERPAVE 12.5 MM FOR SURFACE, PG 64-22, LEVEL 2
- 4.5" HOT MIX ASPHALT SUPERPAVE 19.0 MM FOR BASE, PG 64-22, LEVEL 2 (TWO 2.25" LIFTS)
- 12" GRADED AGGREGATE BASE COURSE (TWO 6" LIFTS)

CECIL COUNTY DEPARTMENT OF PUBLIC WORKS	STANDARD ROAD & STREET DETAILS	REVISED
	METHOD OF CUTTING & REPAIRING OPENING IN EXISTING ROADWAYS	05/07
		R-31

CECIL COUNTY DEPARTMENT OF PUBLIC WORKS ENGINEERING AND CONSTRUCTION DIVISION

MARLEY ROAD SEWER EXTENSION
TRAFFIC CONTROL PLAN AND NOTES

DESIGNED BY	AL	PROJECT NO.	32152-008
DRAWN BY	MJB	SCALE	NOT TO SCALE
CHECKED BY	JCS	DATE	FEBRUARY 2018

DRAWING NO.	T-1	SHEET NO.	8 OF 10
-------------	-----	-----------	---------

NO.	ISSUED FOR	DATE	BY

THE SCALE BAR SHOWN BELOW MEASURES ONE INCH LONG ON THE ORIGINAL DRAWING

Hazen
HAZEN AND SAWYER
1 SOUTH STREET, SUITE 1150; BALTIMORE, MD 21202
410-539-7681

PROFESSIONAL CERTIFICATION:
I HEREBY CERTIFY THAT THESE DOCUMENTS WERE PREPARED OR APPROVED BY ME, AND THAT I AM A DULY LICENSED PROFESSIONAL ENGINEER UNDER THE LAWS OF THE STATE OF MARYLAND, LICENSE No. 21757, EXPIRATION DATE: 10/24/2019

STATE OF MARYLAND PROFESSIONAL ENGINEER ENGINEER'S SEAL 2/2/18